

WIFI

WIFI VISUAL INTERCOM DOORBELL



WIFI VISUAL INTERCOM DOORBELL

Catalogue

Introduction of product	1
Port Definition	2-5
POE connection diagram	6
Android Configuring Network	7-10
IOS Configuring Network	11-15
Edit Account Information	16
System Setting	17
White list settings	18
Alarm Settings	19
Time Settings	20
I/O Setting	20
Update Firmware	21
Lock control settings	22
Features	23
Proactive Monitoring	23
Call Intercom	24
Real-time alarm	25
Specification	26

Introduction of product

WIFI Visual intercom doorbell is a doorbell work with wifi. It connect with home wifi or wired LAN achieve two-way intercom between doorbell and cell phone. When visitors press the doorbell, doorbell sounds and meanwhile camera will start to work sending real-time picture and call to smart phone. User receive the call and see the video to check who is outside, can intercom with visitors and remotely unlock door etc.

WIFI Visual intercom doorbell have alarm and remote control functions, make your home security has more powerful barrier. Advance infrared light design make users can distinguish the visitors in the evening. AC/DC power supply, eliminate the troubles of frequently replacing battery.

2.4G wifi transmission systems, real-time video transmission, Audio and video data transmission band up to 100M band at most, Support Android OS and Iphone OS. One doorbell can connect with Multi cell phone at the same time. Make you and your family can monitor home outdoor surroundings from anywhere. Pass CE, ROHS certification.

Thank you for your support of this products, your satisfaction is our aim!

Port Definition

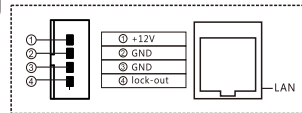
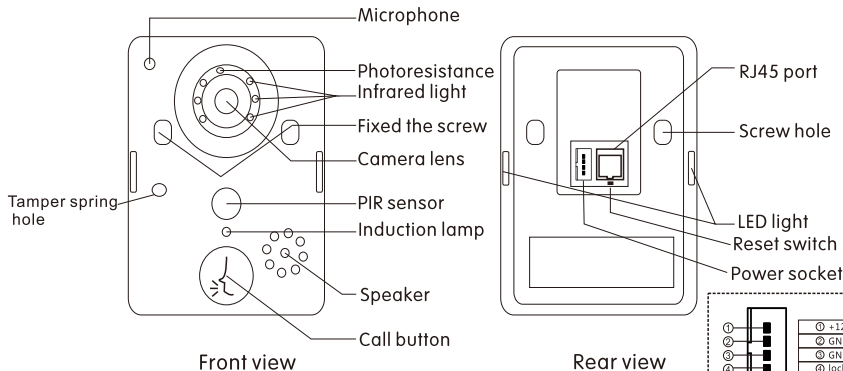

Rear connection diagram

Installation Steps:

1. Switch four screws in the top part and bottom part. Open the cover from middle position, connect 12V/1A power wire.
2. According to the installation diagram and the wiring diagram to install good products, good locks and turning on the power supply connection.
3. Fix the doorbell and 86 ix with.
4. Cover up the cover just opened, and install the 4 screws to finish.

Accessories

Screws(standard)、User manual、Power Supply、The interface line、Tamper spring.

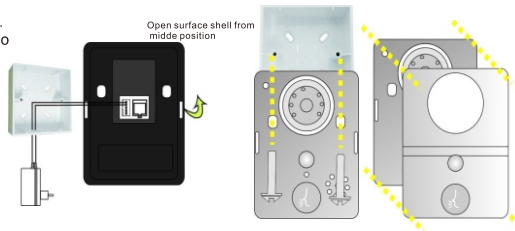

Port Definition

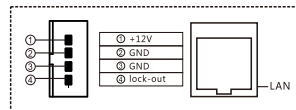
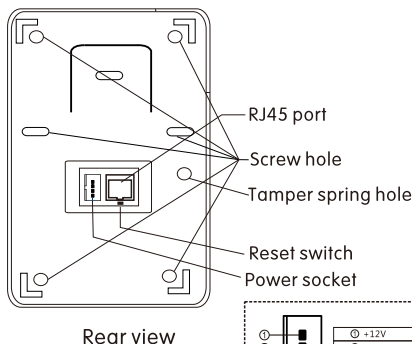
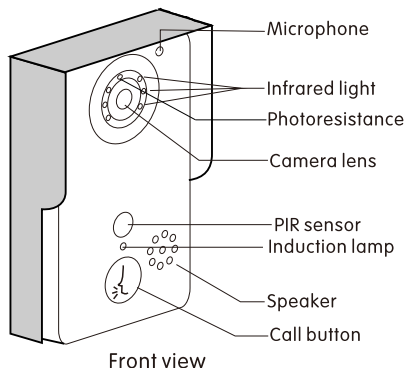

Installation Steps:

- 1.Connect to 12V 1A power cord.
- 2.Use two screws fixed on the 86 pan the waterproof cover.
- 3.The tamper spring mounted tamper spring holes.
- 4.The doorbell push down buckle waterproof cover, anti-theft lock screw.

Accessories

Screws(standard)、User manual、Power Supply、
The interface line、Tamper spring、Hexagon wrench.

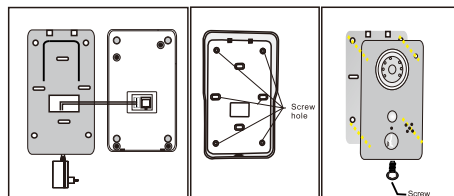

Port Definition

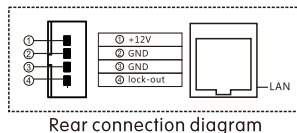
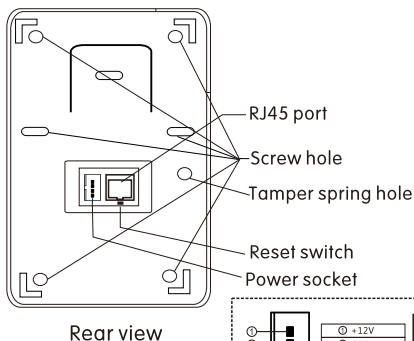
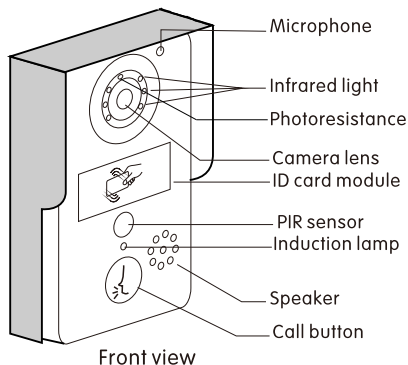

Installation Steps:

1. Connect to 12V 1A power cord.
2. Use two screws fixed on the 86 pan the waterproof cover.
3. The tamper spring mounted tamper spring holes.
4. The doorbell push down buckle waterproof cover, anti-theft lock screw.

ID card settings:

1. Add new user card: brush added card → refresh user card → brush added card.
2. Delete user card: Brush delete card → Brush card → Brush delete card.
3. The user can brush the lock, increase and delete card can only be used to delete the user card, can not unlock.

Accessories

Screws(standard)、User manual、Power Supply、The interface line、Tamper spring、Hexagon wrench、ID keys.

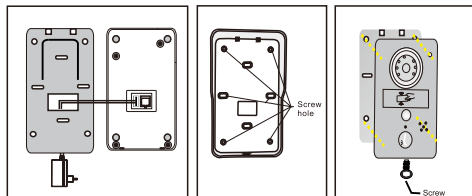

Port Defination

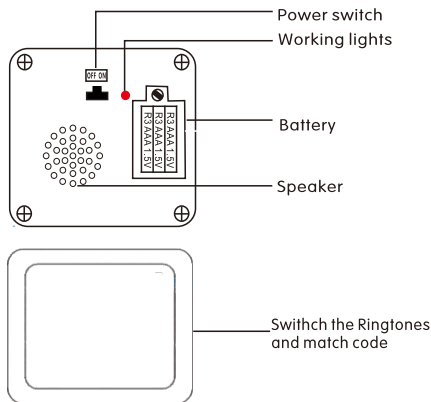

Installation Steps:

With two screws fixed on the wall,
the little bell hanging on the screw.

Accessories

Screws(standard)、User manual、 Expansion rubber plug.

Smart bell instructions

- 1.Loaded on three AAA batteries.
- 2.Power switch to the ON position,Working lights flash one time.
- 3.Press the top-cover until the working light flashing,the code,WIFI bell on the power,according to the call button several times,lights out and ring at the same time matching success,the ID in the first group.Repeat matching,ID into the second and the third group,and so on.
- 4.38 music ringtones,Click on the roof can switch aringtone.
- 5.Can match three WIFI doorbell.
- 6.Once press the WIFI doorphone call buttons smart bell will ring.

Installation drawing

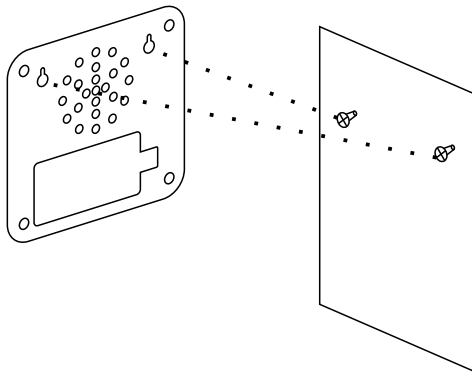

POE connection diagram

POE switching power supply

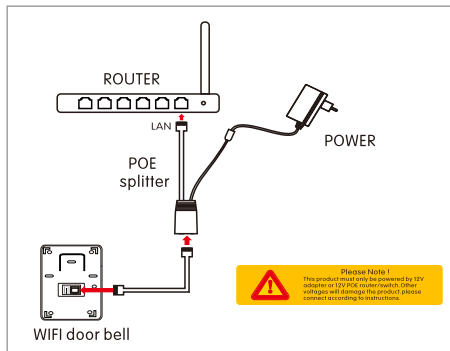

Direct power

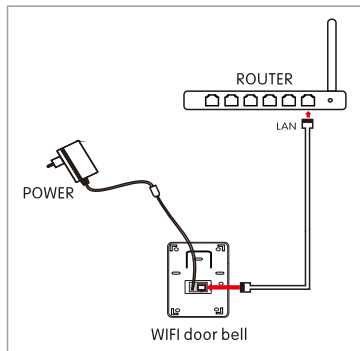

Restore factory settings

Method One:

After electrify, hold the call button for the first time for 10 seconds after let go, can hear the bell A successful prompt. If not the first time calling key press or by several times again, you need to power after electrify to take effect.



Method Two:

On the back of the product, long press the reset button for three seconds after let go, can hear the bell reset successful prompt.

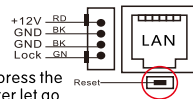

Android APP download [🤖]



Android market in China



Google play

Note: Android phones with WeChat scan need to open in a browser to download the APP.

Add the doorbell [🤖]

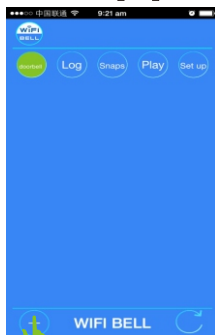

1. Open the software after, Click the add button.

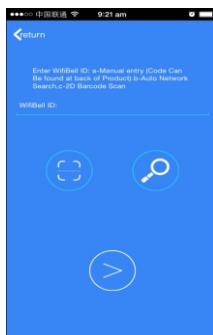

2. Input the doorbell ID, ID number on the back of the product, Manually enter or scan the qr code input automatically.

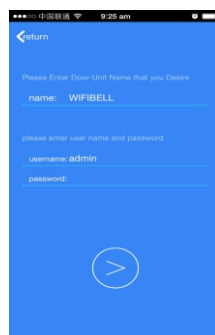

3. Add user will default to the administrator for the first time, Password is empty, After the success of the configuration of network, If the other cell phone users login please enter the correct user name and password.

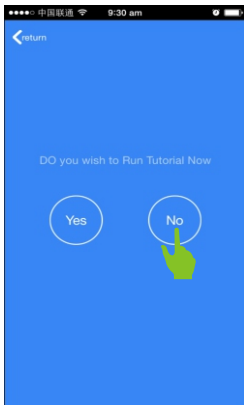

4.Choose NO.



5.Add doorbell successful.

WIFI setting [Android]



1. Connect a network cable from the router to insert the LAN port that on the back of the product.



2. If using the wireless connection, click , then choose the network.

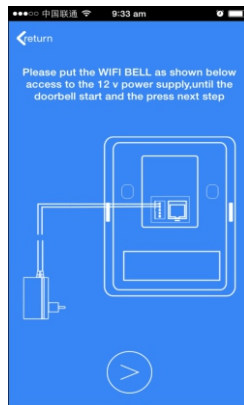

3. If the equipment is started successfully, click next step, if the equipment didn't power on. Please plugged in and waiting for the equipment started successful, then click next.

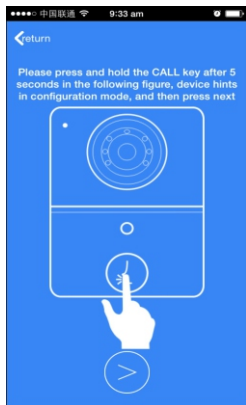

1. Hold the call button for five seconds then let go, device will say "the system has to enter configuration mode..."

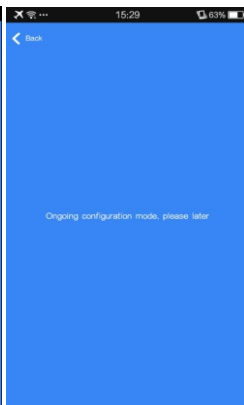

2. Android mobile phone automatically connected device hot and jump instructions on the next.

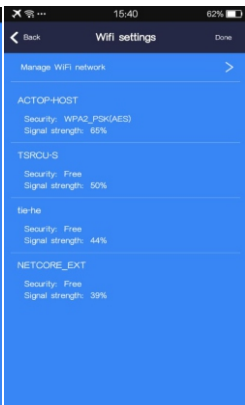

3. Choose the WIFI hotspot which need to configure, then click it.

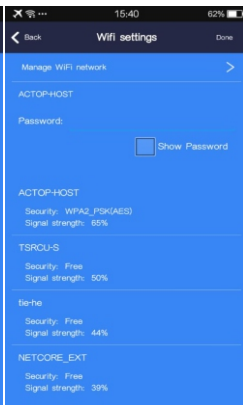

4. Input the WIFI password, click Done.

IOS APP download [🍏]



IOS

Add the doorbell [🍏]

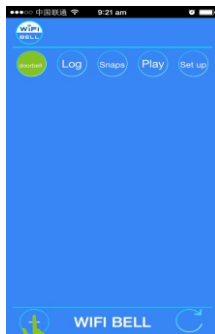

1. Open the software after, Click the add button.

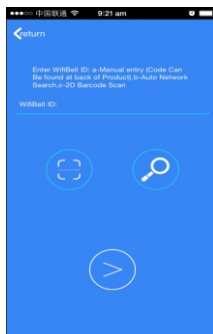

2. Input the doorbell ID, ID number on the back of the product, Manually enter or scan the qr code input automatically.



3. Add user will default to the administrator for the first time, Password is empty. After the success of the configuration of network, If the other cell phone users login please enter the correct user name and password.

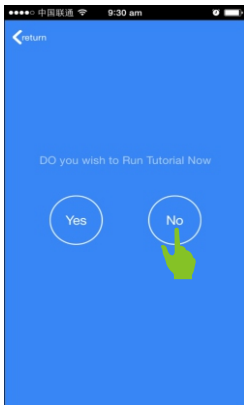

4.Choose NO.



5.Add doorbell successful.

WIFI setting [🍏]



1. Connect a network cable from the router to insert the LAN port that on the back of the product.



2. If using the wireless connection, click , then choose the network.

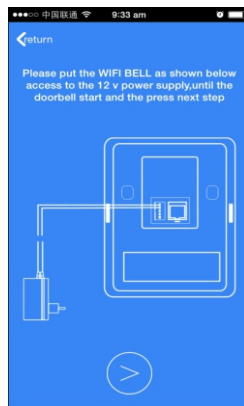

3. If the equipment is started successfully, click next step, if the equipment didn't power on. Please plugged in and waiting for the equipment started successful, then click next.

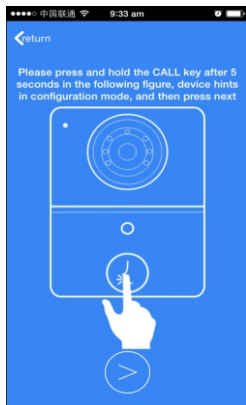

1. Hold the call button for five seconds then let go, device will say "the system has to enter configuration mode..."

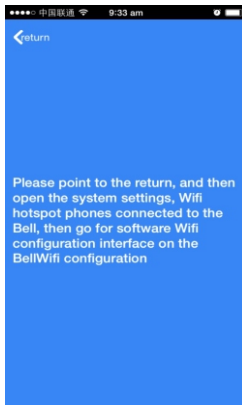

2. IOS system setting according to this instructions.

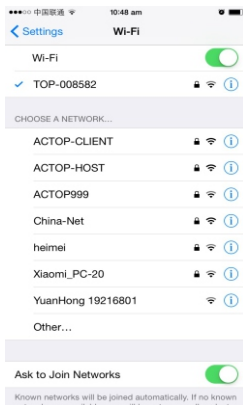

3. Connect "TOP..." WIFI hotspot password is 123456789.



4. Enter the main interface, click settings.

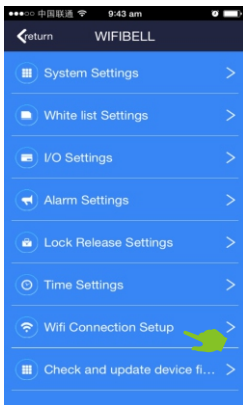

4.Choose WIFI Settings.

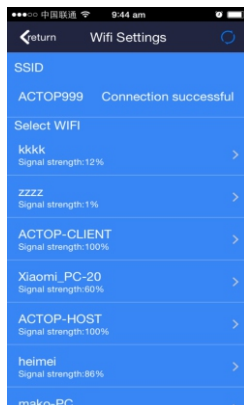

5.Choose the need to be configured
WIFI hotspot WIFI password input
Click finish, the bell will be restarted.

Edit Account Information [Android] [Apple]

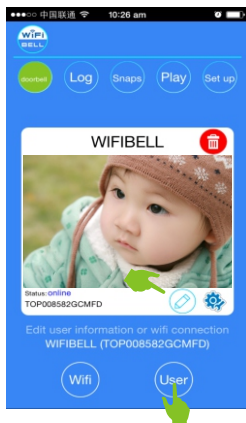

1. Click  selection user.

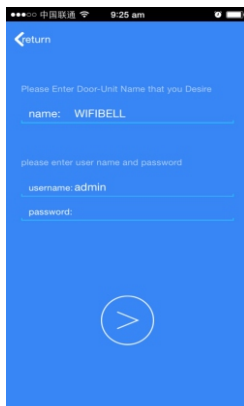

2. Modify the bell name.

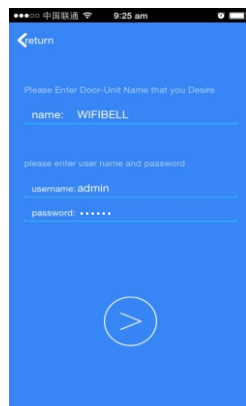

3. Switch the user information.

System setting [Android] [Apple]

1. Voice promapt switch: When the voice prompt is open, Can choose to open or closethe voice prompt.
The factory default open.

2. Configuration mode switch: When configuration mode is open, Can choose to open or close the configitation mode. The factory default open.

3. The monitor time: Can be set up in 10–300 seconds.

4. The talk time: Can be set up in 10–300 seconds.

5. The call waiting time: Can be set up in 30–90 seconds.

IOS system can be set up in 30–90 seconds.

Special remind: Only Administrators have access to system settings.

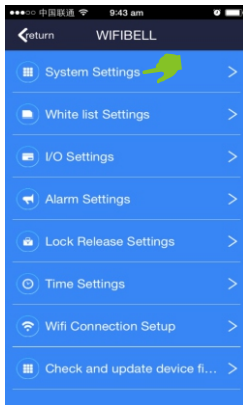

White list Settings [Android][Apple]

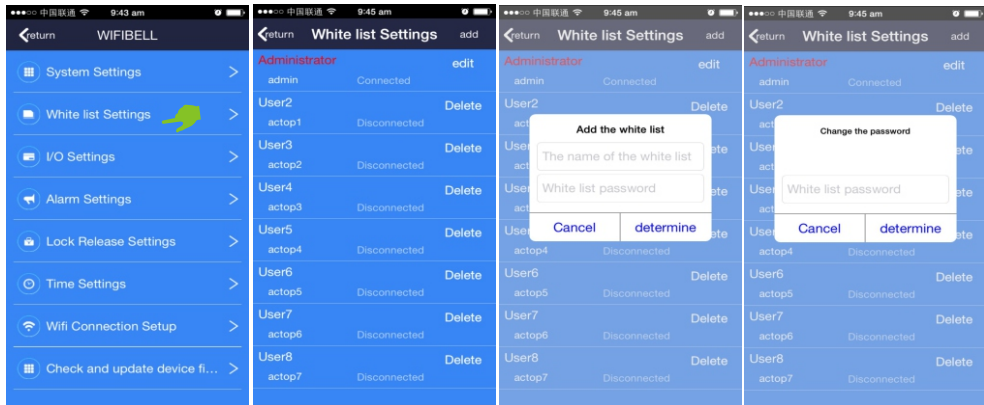

- 1.Chose white list setting.
- 2.Click add options on the top right corner.
- 3.Enter the user name and password that you want to add, Up to seven can be added to the user.
- 4.Click the editing options behind the asministrator can reset the administrator password,Need to login again after reset the password.

Alarm settings [Android] [Apple]

When alarm turn off(Disarm) Any alarms are not notified to cellphone
1.when alarm turn on(Arming) User can set up other parameters further.

A.Alarm type:Motion detection,PIR and so on.

B.1-5

C.Alarm delay

D.Alarm e

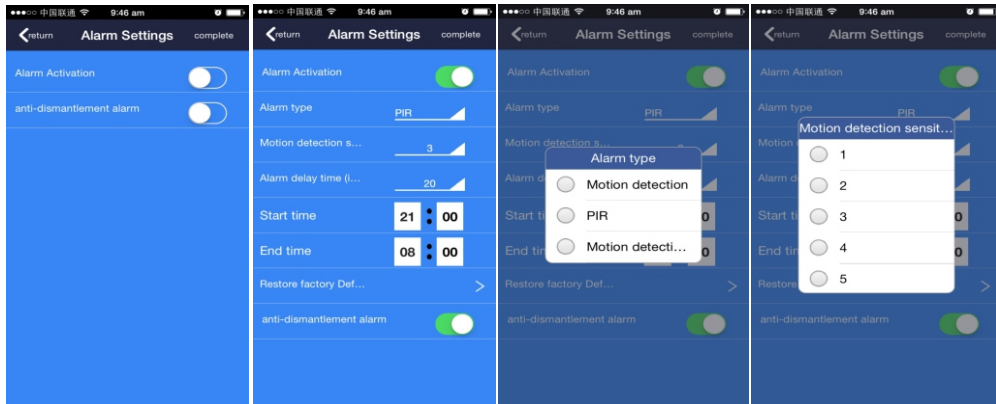

Time Settings [Android] [Apple]

According to actual situation, set correct time zone. The unity of time for automatic calibration via internet

I/O Settings [Android] [Apple]

Used to define extended IO control, as well as the linkage function.

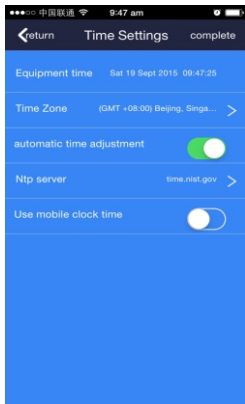

1. Equipment time Settings, can choose the time zone or the use of mobile phone time calibration.

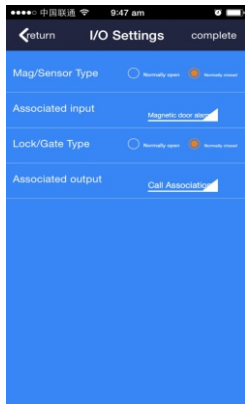

2. Interface setting.

Update Firmware [Android][Apple]

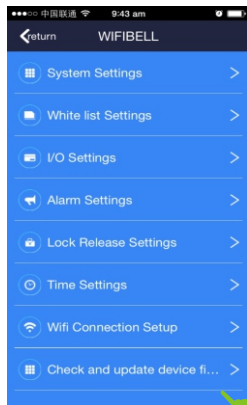

1.Choose the update device firmware.

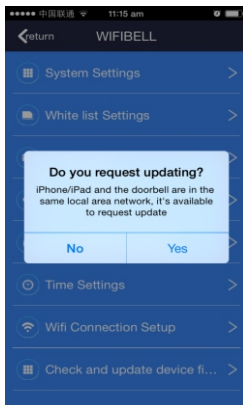

2.Click yes to upgrade.

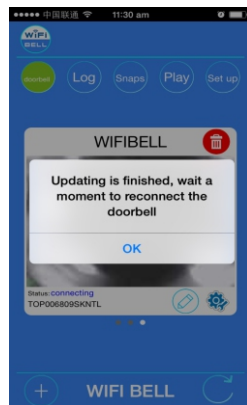

3.Download the new firmware.

Lock control settings [Android] [Apple]



1. Click Settings.

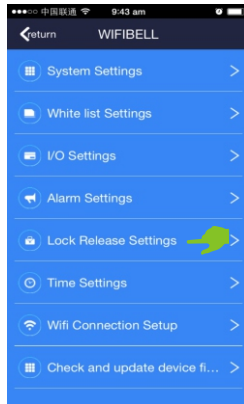

2. Enter the lock control settings.

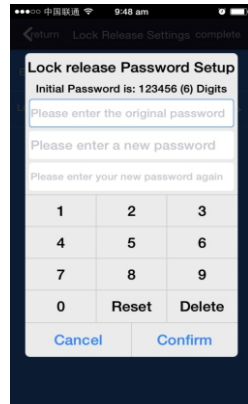

3. Modify the unlock password.

Features [Android] [Apple]

Proactive monitoring



1. In the main interface, click the doorbell device directly (online), you can proactively monitor.

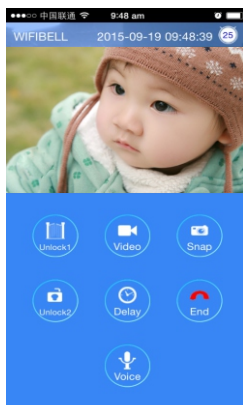

2. In the surveillance video interface/camera, calls can be remote unlocking.

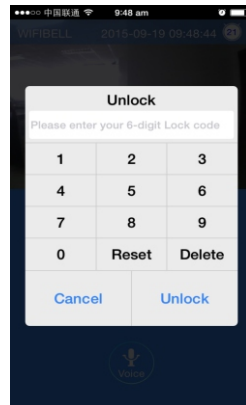

3. WIFIBELL 602A can support users open the lock. Click the lock/Enter a password to unlock.

Call Intercom



1. Presses the doorbell to call, click on the red hang up the green answer.

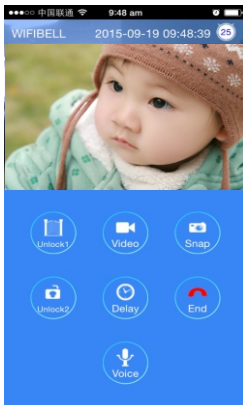

2. After answering a cell phone to any other phone will automatically hang up. In the course of conversation, you can remotely lock. Press and hold the voice icon, you can send word to the doorbell. Delay button, you can extend this talk time. End the call, press (hang up) button.

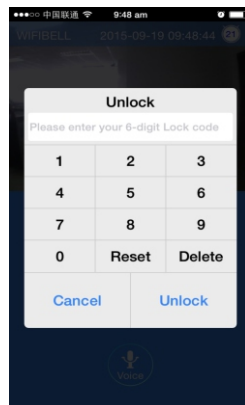

3. WIFIBELL602A can support users open the lock. Click the lock/Enter a password to unlock.

Real-time alarm

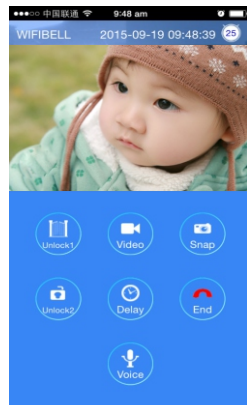
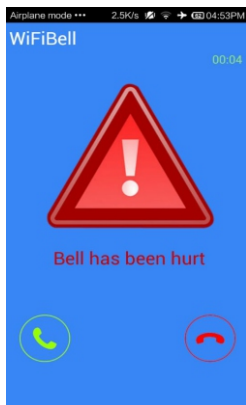

1. When an alarm occurs, all the added phone will immediately be notified. Click on the green answer key, you can turn on the device for real-time monitoring. Slide the red hang up button, you can hang up. Central interface displays an alarm occurs the instant photo.

2. Illegal destruction of the bell, the mobile terminal received super alarm prompt, monitoring or hang up after to answer.

3. Alarm monitoring, but not remote unlocking alarm monitoring, but not remote unlocking.

Specification

Camera	1/4"/F2.4/110
Distinguishability	640 × 480
Illumination	2 LUX
Light source	6PCS Infrared light
Power	Standby:DC 12 1A
Powerdissipation	Standby 1.5W,Working 3.8W

Notes

- 1.Our company is committed to reform and innovation,and reserves the right to make changes and improvements without further notice.Illustrations in this manual are for reference only.
- 2.All warranty and liability is void should you or your dealer open the unit with out authorization or remove/deface the product labeling.
- 3.Warranty:For one year from purchasing this product,we promise to provide you with free maintenance and technical support.This excludes damage during installation,unauthorized tampering and willful damage.
- 4.Warranty periods different from this cannot be support by the manufacturer.